



## Features

### High Throughput

- The instrument can digest 40 samples in a run, which makes experiment move efficient.

### Multiple Security Protection

- Multiple safety measures ensure temperature and pressure are controlled for security.

### Focus on User Experience

- Equipped with external 8 inches touch screen.
- Floor standing design saves space and makes it easy to load and take out of vessels.
- Semi-automatic lid-opening system with explosion-proof mechanical design is convenient to operate.

### Stable and Efficient Microwave Output Technology

- Non-pulsed continuous microwave technology enables automatic and linear change of microwave power output based on temperature and pressure feedback signals which improves stability, and safety.

### Fast Cooling Technology

- Multiple high-power turbulent air cooling systems enable rapid air cooling which reduces digestion time and improves efficiency.

## High-Throughput Microwave Digestion System

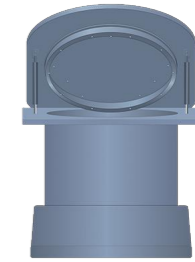

### Fully Thermal Insulation and Corrosion Resistance Design

- 316 industrial stainless steel chamber with multi layer coating insulates heat and avoid corrosion.

### Precise Temperature And Pressure Control Technology

- Multiple non-contact temperature and pressure measurement systems are configured to accurately measure and adjust according to feedback signals.

### Subtle Design For Uniform Handling

- The 360° rotator reduces drive shaft loss and improves sample processing uniformity by periodically changing vessel position.

## Technical Specification

Model	WMD4000
Vessel Quantity	40
Vessel Volume	50mL
Temperature Monitoring	Contactless IR Sensor
Display	7 Inches Touch Screen
Maximum Working Pressure	6 MPa
Temperature Control Range	50~400 °C
Dimension	640*630*590mm
Maximum Working Temperatur	250 C
Inner Vessel Temperature Limit	300 °C
Rotation Mode	360 Continuous Rotation
Microwave Power	0-3000W Adjustable
Temperature Control	Scanning Control Of Each Vessel
Pressure Testing	Contactless Pressure Sensor
Vessel material	Inner: Imported TFM Outer: Imported PEEK+Glass Fiber
Pressure Control range	0-10MPa
Pressure Control Accuracy	0.01MPa
Power	AC 220V, 16A, 50/60Hz
Weight	78KG
Temperature Control Accuracy	±0.3°C
Microwave Frequency	2450Hz
Microwave Leak	<5mw/cm <sup>2</sup>

## Touch Screen Interface

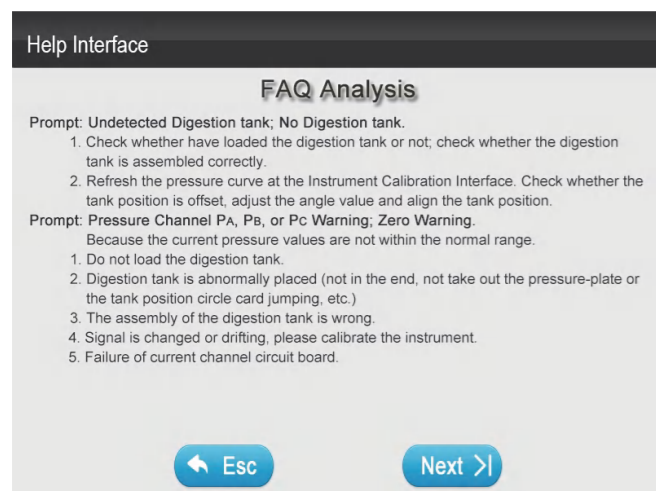
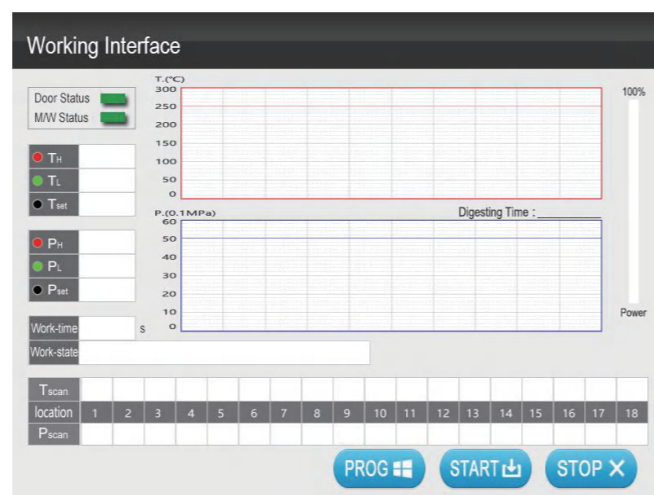
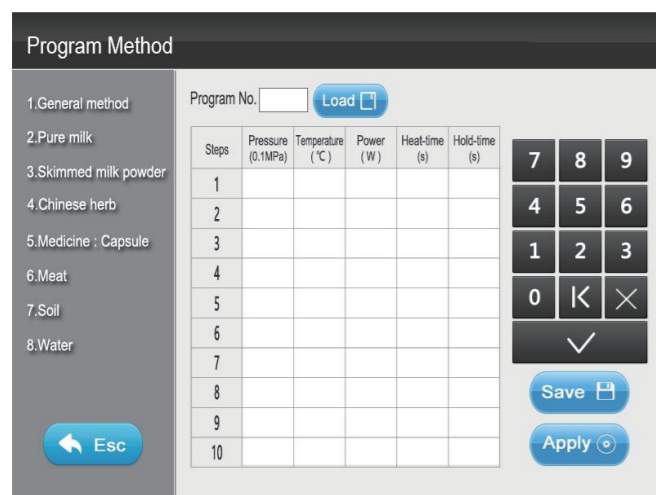
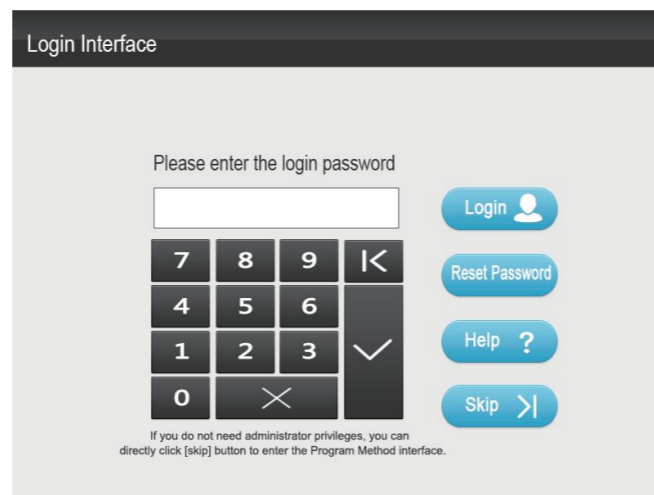
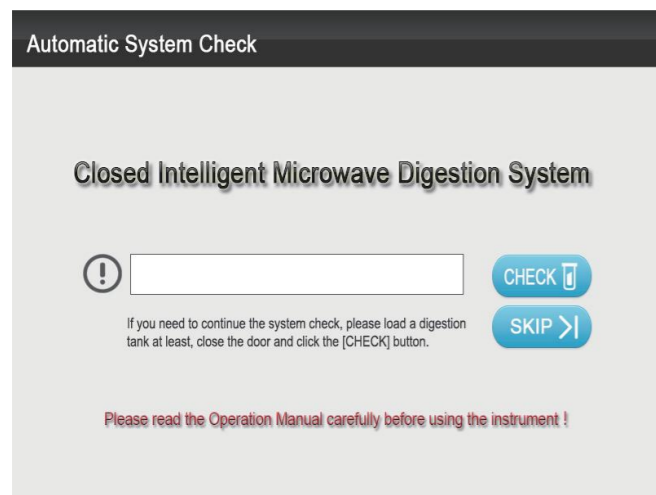

## Heating Blocks

Heating blocks is the optional accessory of Metash microwave digestion system.

It is mainly used for pre-heating of some food, cosmetics and organic samples to check the intensity of sample reaction before digestion; it is also used for acid evaporation after digestion.



## Features

- Coated with PFA which is of high temperature and corrosion resistance, also extends device service life.
- Equipped with AI and PID smart temperature controlling system to realize automatic temperature adjustment and improve the accuracy.
- Over-temperature protection and alarm system greatly improve experiment safety.

## Touch Screen Interface

Model	WPBM-200	WPBM-400	WPBM-500
Sample Number	12	20	56
Applicable Models	WMD600 Series	WMD1200R/1800R	WMD4000
Aperture And Hole Depth	Φ 39*65mm	Φ 41*150mm	Φ 32*118mm
TemperatureControl Range	RM Temperature~250°C	RM Temperature~250°C	RM Temperature~250°C
Temperatur Control Accuracy	±0.5°C	±0.5°C	±0.5°C
Temperature Setting Resolution	0.1°C	0.1°C	0.1°C
Heating Power	1600W	2000W	2000W
Power	AC220V±10%	AC220V±10%	AC220V±10%
Weight	13kg	34kg	40kg